

CRUX

**Coffee Grinder
Instruction Manual**

Styled for Life
Designed & Engineered in New York City

Table of Contents

Important Safeguards.....	2-3
Additional Important Safeguards	4-5
Notes on the Cord	5
Notes on the Plug	5
Plasticizer Warning.....	5
Getting To Know Your Coffee Grinder	6
Grinding Coffee Beans	7
Grinding Spices.....	7
Before Using for the First Time	8
Operating Instructions.....	8-9
User Maintenance Instructions.....	9
Care & Cleaning Instructions	9
Storing Instructions	9
Warranty	10-11

IMPORTANT SAFEGUARDS

When using electrical appliances, basic safety precautions should always be followed including the following:

- 1. READ ALL INSTRUCTIONS.**
2. To protect against risk of electrical shock do not put cord, plugs, or appliance in water or other liquid. Ensure that appliance does not get wet (water splashes etc.) and do not use it with wet hands.
3. This appliance is not intended for use by persons (including children) with reduced physical, sensory or mental capabilities, or lack of experience and knowledge, unless they have been given supervision or instruction concerning use of the appliances by a person responsible for their safety.
4. Children should be supervised to ensure that they do not play with the appliance.
5. Unplug from outlet when not in use, before putting on or taking off parts, and before cleaning. You might accidentally start the appliance if the unit is still plugged into the outlet and cause serious personal injury.
6. Avoid contacting moving parts. Blades are sharp and spin at a high speed and can cause injuries.
7. Do not operate any appliance with a damaged cord or plug or after the appliance malfunctions, or has been damaged in any manner. Bring it to a qualified technician for examination, repair or electrical or mechanical adjustment.

8. The use of attachments not recommended or sold by the manufacturer may cause a risk of injury to persons. Only items designed for use with this appliance should be used at all times.
9. Do not use outdoors. This unit is designed to be used only indoors.
10. Do not let cord hang over edge of table or counter. The cord can get tangled or cause the appliance to fall.
11. Do not let cord contact hot surface, including the stove. The protective insulation will burn making the appliance inoperable or unsafe to operate.
12. The blades is sharp. Handle carefully. Touching the blades can cause injuries.
13. Be certain cover is securely in place before operating appliance, to prevent injury or bodily harm
14. Do not attempt to defeat the cover interlock mechanism. Its design ensures user safety from sharp moving parts.

**FOR HOUSEHOLD
USE ONLY**

**SAVE THESE
INSTRUCTIONS**

ADDITIONAL IMPORTANT SAFEGUARDS

1. All users of this appliance must read and understand this owner's manual before operating or cleaning this appliance.
2. The cord to this appliance should be plugged into a 120 V ac electrical outlet only.
3. Do not leave this appliance unattended during use.
4. If this appliance begins to malfunction during use, immediately release the Pulse/on button and unplug the cord. Do not use or attempt to repair the malfunctioning appliance. A damaged appliance may cause serious personal injury, start fires, or cause property damage.
5. If this appliance falls or accidentally becomes immersed in water, unplug it immediately. Do not reach into the water! Do not use this appliance after it has fallen into or becomes immersed in water, unplug it immediately. Do not reach into the water due to the danger of electrocution.
6. To reduce the risk of injury to persons or property, never use this appliance in an unstable position.
7. Do not use this appliance for other than its intended use. The appliance may be damaged and cause serious personal injury, start fires, or cause property damage.
8. The blade is very sharp and can cause injury if touched.

9. This coffee grinder is intended for processing beans and spices.
10. Never use for extended periods of time.
11. Do not operate the coffee grinder without the lid in place.
12. Do not use if the lid is cracked or chipped.

Notes on the Cord

The provided short power-supply cord should be used to reduce the risk resulting from becoming entangled in or tripping over a longer cord. An extension cord is not recommended for use with this product.

Notes on the Plug

This appliance has a polarized plug (one blade is wider than the other). To reduce the risk of electric shock, this plug is intended to fit into a polarized outlet only one way. If the plug does not fit fully into the outlet, reverse the plug. If it still does not fit, contact a qualified electrician. Do not attempt to modify the plug in any way.

Plasticizer Warning

CAUTION: To prevent Plasticizers from migrating to the finish of the counter top or table top or other furniture,

place NON-PLASTIC coasters or place mats between the appliance and the finish of the counter top or table top.

Failure to do so may cause the finish to darken; permanent blemishes may occur or stains can appear.

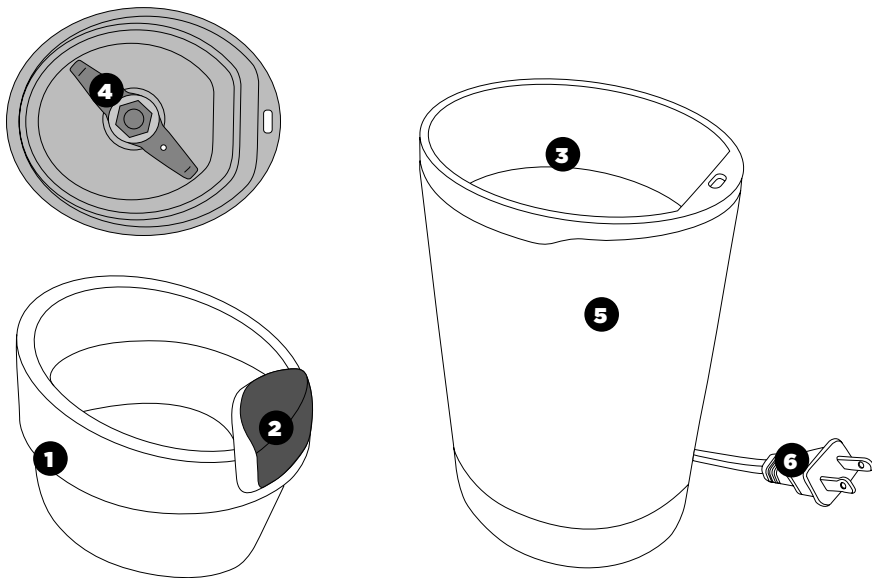

Getting To Know Your Coffee Grinder

Product may vary slightly from illustration

- | | | |
|--------------------|-----------------------------------|-------------------|
| 1. Clear Lid | 3. Stainless steel bowl | 5. Housing |
| 2. Grinding button | 4. Stainless steel grinding blade | 6. Polarized Plug |

Grinding Coffee Beans

- This coffee grinder will hold up to 1/3 cup (75 g) whole coffee beans at a time. On average, this will produce approximately 8 level tablespoons of ground coffee.

NOTE: Consult your coffee maker instructions for the recommended grind - then adjust to your own taste.

- Fresh beans will yield the best flavor and aroma.
- For the freshest, most flavorful cup of coffee, grind only enough coffee for the pot you are brewing. If you are brewing a large pot, you may need to grind coffee beans in several batches.
- Press the GRINDING button. Grind coffee beans for up to 20 seconds at a time. Continue grinding until desired. A fine grind exposes more surface to the water and therefore a more rapid rate of extraction of flavor.
- A coarser grind, which exposes little surface, is appropriate for the longer brewing cycle of percolators.
- **IMPORTANT:** Experimenting with the length of grind time will enable you to get exactly the grind you prefer for your coffee.

Grinding Spices

Spices pack more flavor when freshly ground. It is recommended to grind only spice seeds such as peppercorn, mustard seeds, coriander seeds etc. Follow the same instructions as listed for grinding coffee beans.

Not Recommended

- This coffee grinder WILL NOT GRIND anything which is moist, gummy or extremely hard: ice, chocolate, whole nutmeg, candied ginger, etc.
- This coffee grinder will NOT make pastes of any kind from seeds such as sunflower or sesame.
- Never add oils or liquids while grinding.
- Grains such as corn, wheat, rice, barley, and rye may cause damage to the lid.
- Chopping, mincing or pureeing of soft foods is not recommended.

Before Using for the First Time

1. Wipe the stainless steel bowl, blade, and lid with a damp cloth.
2. Make sure the inside parts are completely dry before using.

Operating Instructions

1. Remove lid, make sure the grinder is empty and clean.
2. Place coffee or other foods (do not exceed 75g) into the stainless steel bowl.
3. Place the lid on the coffee grinder, with the GRINDING button side facing front.
4. Plug coffee grinder into a 120V AC electrical outlet.
5. Hold the coffee grinder in place with one hand, making sure the lid is securely in position. Press and hold the GRINDING button.
6. Grind beans until the desired consistency has been reached. Do not exceed 20 seconds of grinding at one time.
When pressure is released from the GRINDING button, the coffee grinder stainless steel blade will stop.
7. Remove the lid and check consistency. If additional grinding is necessary, place the lid back onto the coffee grinder, then press and hold the GRINDING button to continue grinding. When the blade stops, unplug the coffee grinder.
8. To unload the stainless steel bowl, carefully pull lid up and off the housing. Use a coffee scoop to transfer freshly ground coffee beans to your coffee filter. (See Figure 2.) Tap the top of the housing lightly until the ground coffee (or other ground food) drops into stainless steel bowl.
9. Store unused ground coffee in an airtight container future use.

Figure 2

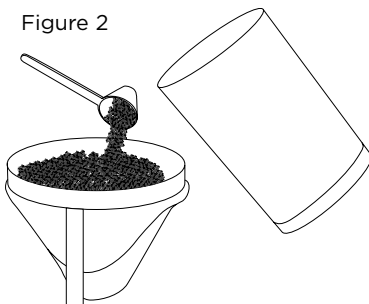

10. Clean coffee grinder according to Care & Cleaning Instructions described in this instruction manual.

11. THIS PRODUCT IS FOR HOUSEHOLD USE ONLY.

User Maintenance Instructions

This appliance requires little maintenance. It contains no user-serviceable parts. Any servicing requiring disassembly other than cleaning must be performed by a qualified appliance repair technician.

Care & Cleaning Instructions

WARNING: DO NOT IMMERSE THE MOTOR BASE IN WATER. DO NOT PLACE COFFEE GRINDER IN THE DISHWASHER!

1. Unplug the coffee grinder.
2. Wipe the stainless steel blade, stainless steel bowl and exterior with a damp cloth or paper towel to remove any excess ground coffee or ground foods.
3. Use a small, dry brush to help dislodge dry particles of food.
4. The lid should be washed in warm, soapy water, rinsed and completely dried.
5. Make sure to clean completely after each use to prevent flavors from one food being transferred to the next. Make sure to check under the blade as food can collect there.
6. To dislodge any stubborn food particles, place the lid on the coffee grinder, press and hold the GRINDING button and grind for 3 to 5 seconds with an empty stainless steel bowl.

Storing Instructions

1. Unplug the coffee grinder. Store in its box or in a clean, dry place.
WARNING: Never store the coffee grinder while it is plugged in.
2. Wrap cord in the cord storage area located on the bottom of the coffee grinder.
3. Do not put any stress on the cord where it enters unit, as this could cause cord to fray and break.

Limited Two-Year Warranty

SENSIO Inc. hereby warrants that for a period of **TWO YEARS** from the date of purchase, this product will be free from mechanical defects in material and workmanship, and for 90 days in respect to non-mechanical parts. At its sole discretion, SENSIO Inc. will either repair or replace the product found to be defective, or issue a refund on the product during the warranty period.

The warranty is only valid for the original retail purchaser from the date of initial retail purchase and is not transferable. Keep the original sales receipt, as proof of purchase is required to obtain warranty validation. Retail stores selling this product do not have the right to alter, modify, or in any way revise the terms and conditions of the warranty.

Exclusions:

The warranty does not cover normal wear of parts or damage resulting from any of the following: negligent use of the product, use of improper voltage or current, improper routine maintenance, use contrary to the operating instructions, disassembly, repair, or alteration by anyone other than qualified SENSIO Inc. personnel. Also, the warranty does not cover Acts of God such as fire, floods, hurricanes, or tornadoes.

SENSIO Inc. shall not be liable for any incidental or consequential damages caused by the breach of any express or implied warranty.

Apart from the extent prohibited by applicable law, any implied warranty of merchantability or fitness for a particular purpose is limited in time to the duration of the warranty. Some states, provinces or jurisdictions do not allow the exclusion or limitation of incidental or consequential damages, or limitations on how long an implied warranty lasts, and therefore, the above exclusions or limitations may not apply to you. The warranty covers specific legal rights which may vary by state, province and/or jurisdiction.

How To Obtain Warranty Service:

You must contact Customer Service at our toll-free number: 1-866-832-4843. A Customer Service Representative will attempt to resolve warranty issues over the phone. If the Customer Service Representative is unable to resolve the problem, you will be provided with a case number and asked to return the product to SENSIO Inc. Attach a tag to the product that includes: your name, address, daytime contact telephone number, case number, and description of the problem.

Also, include a copy of the original sales receipt. Carefully package the tagged product with the sales receipt, and send it (with shipping and insurance prepaid) to SENSIO Inc.'s address. SENSIO Inc. shall bear no responsibility or liability for the returned product while in transit to SENSIO Inc.'s Customer Service Center.

CRUX

For customer service questions or comments

1-866-832-4843

cruxkitchen.com

 [crux.kitchen](https://www.instagram.com/crux.kitchen)

CRUX is a trademark of 8479950 Canada Inc.
All rights reserved